

Microwave motion detector

CR3

Translation of the original instructions

General

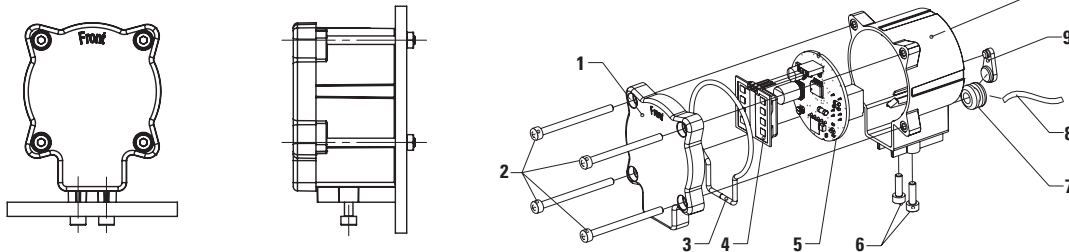

- ① Top cover
- ② Screw
- ③ Sealing
- ④ Radar module
- ⑤ PCB module
- ⑥ Screw
- ⑦ Rubber grommet
- ⑧ Cable
- ⑨ Rubber plug
- ⑩ Cover back

1 Safety instructions

Only trained, qualified personnel may mount and start up the detector.
The unit may only be opened and repaired by the manufacturer.
The unit may only be operated from a safety extra-low voltage (SELV) system with safe electrical separation.
Always consider the safety functions of your application as a whole, never just in relation to one individual section of the system.
The installer is responsible for carrying out a risk assessment and installing the detector and the system correctly. Avoid touching any electronic components.
The rubber plug must be mounted correctly after adjusting potentiometer. Otherwise it will affect protection effect (IP65).

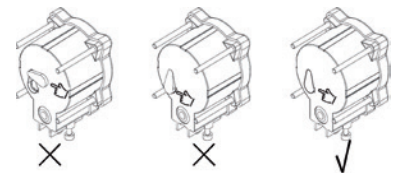

2 Assembly

Mounting of the detector

1. Position drill template
2. Drill the holes, remove drill template
3. Mount detector

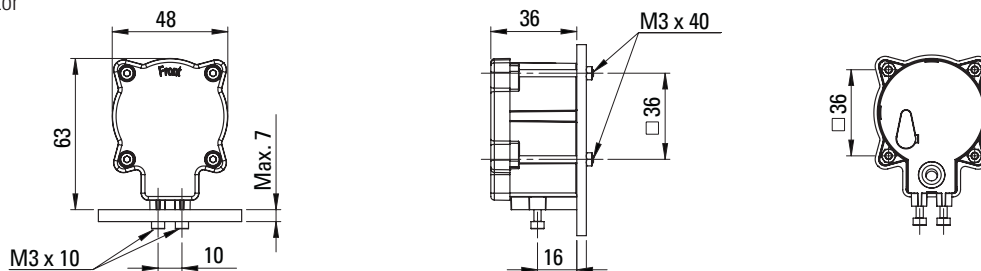

3 Electrical connections

1	white	● - ~	12-28 V AC
2	brown	● + ~	12-36 V DC
3	green	●	48 V AC/DC 30 W / 60 VA
4	yellow	●	
5	grey	●	

4 Field size adjustment



1. Open the lower hole from the gap, don't open the upper hole.
2. Adjust the potentiometer.
3. Mount the rubber plug correctly.

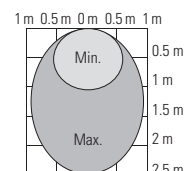
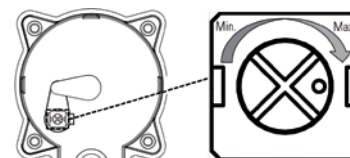

5 Technical data

Technology	Microwave Doppler Radar
Frequency	24.125 GHz
Transmitter radiated power (EIRP)	< 20 dBm
Max. detection distance	2.5 m
Detection mode	Motion
Min. detection speed	3 cm/s (measured in sensor axis)
Supply voltage	12-28 V AC \pm 10% 12-36 V DC + 30%/– 10%
Max. power consumption	1.2 W
Output	Relay with switch-over contact Rated load: 0.5 A at 125 VAC; 1 A at 24 VDC Rated carry current: 2 A Max. switching voltage: 125 VAC, 60 VDC Max. switching current: 1 A
Output hold time	1 s
Temperature range	–20 to +60 °C
Protection class	IP65
Dimension (mm)	63 x 48 x 36 mm (L x W x H)
Materials	ABS

6 EU Declaration of Conformity



See attachment

7 WEEE



Devices with this symbol must be treated separately during disposal. This must be done in accordance with the laws of the respective countries for environmentally sound disposal, processing and recycling of electrical and electronic equipment.

8 FCC approval



This device meets the requirements of Part 15 of the FCC regulations and the RSS-210 standard of Industry Canada.

Warning: Changes or modifications made to this device may void the FCC authorisation to operate this device.

9 Contact

BBC Bircher Smart Access, BBC Bircher AG, Wiesengasse 20, CH-8222 Beringen, www.bircher.com

Made in China / Designed in Switzerland