

# PIR 22

## 被动红外线运动传感器

### 操作说明书中文版

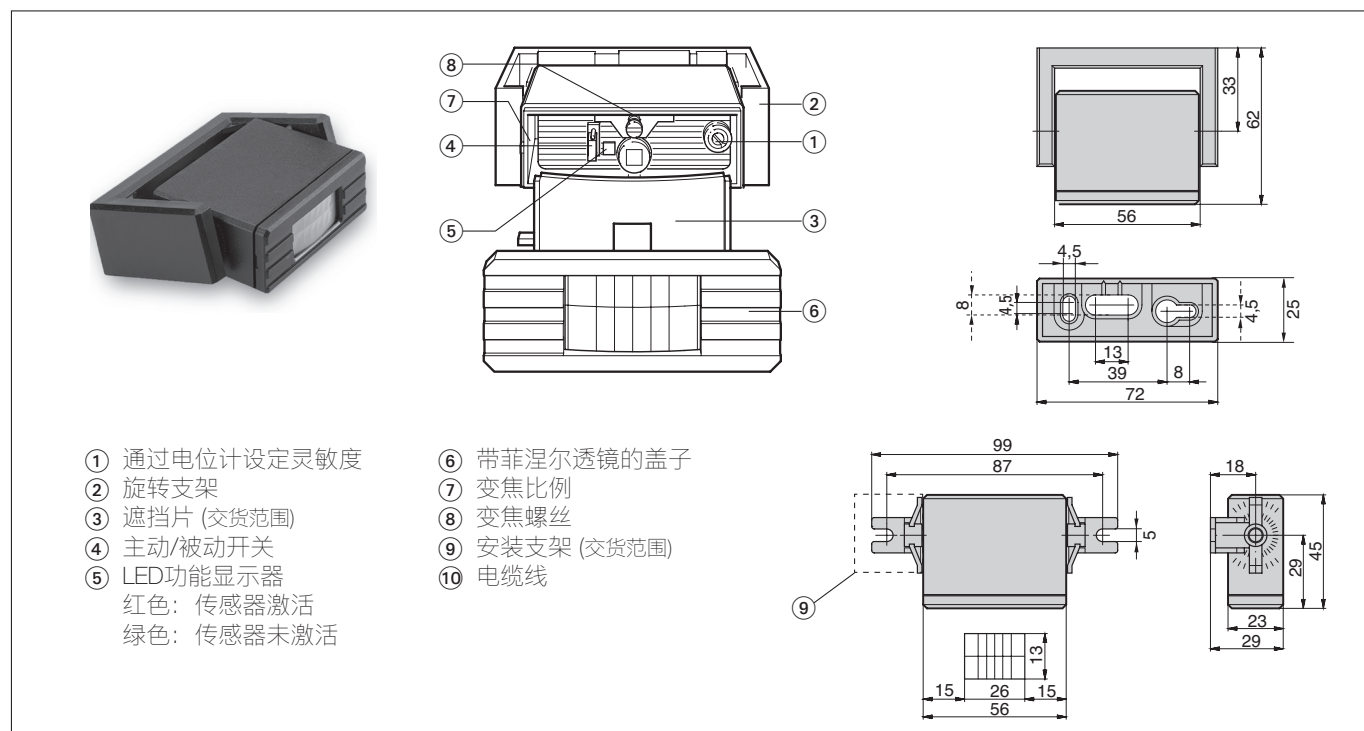

## 1 安全说明

• 在将设备投入运行之前，应先彻底阅读本操作说明，并保留本操作说明以便将来参考。• 本产品设计用于安装在人行门上方。• 禁止将不符合欧盟机械指令的安全部件用于人身保护或紧急停止功能。• 只允许经过培训且有资质的人员安装设备并完成对设备的初始化。• 不遵守这些安全预防措施可能会导致传感器或者物体损坏、人员重伤或者死亡。• 安装人员应负责测试系统，以确保系统满足所有适用的安全标准。• 根据欧洲标准 EN 61558，只允许使用带有安全电气隔离装置的安全特低电压 (SELV) 运行本装置。必须防止布线受到机械损坏。• 原则上避免与光电元器件发生接触。



## 2 安装

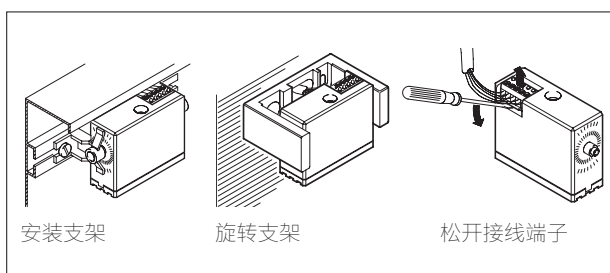

### 天花板安装架 (货号 212822)

尺寸 天花板安装架:  
宽 110 mm, 高 40 mm, 深 37 mm, 透镜区域 14 x 27 mm

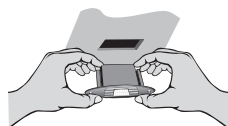

在天花板开孔 (尺寸:  
75 x 26 mm)。将已锁进安装框架的探测器放进孔槽中。

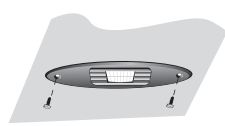

**交货范围**  
2 颗螺栓 (2.9 x 65 mm)  
用于支架安装  
2 颗螺栓 (3.9 x 19 mm)  
用于天花板安装

### 保护盖 (货号 212827)

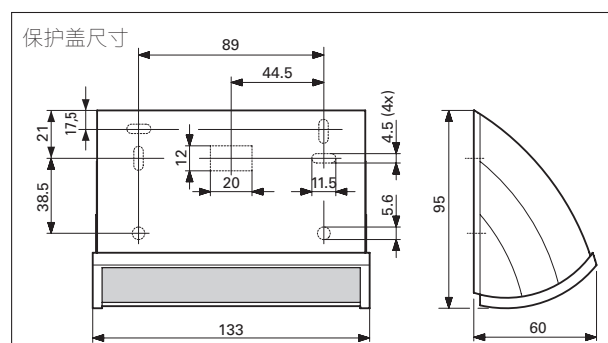
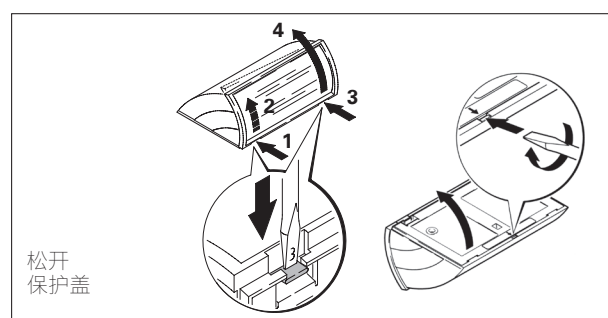
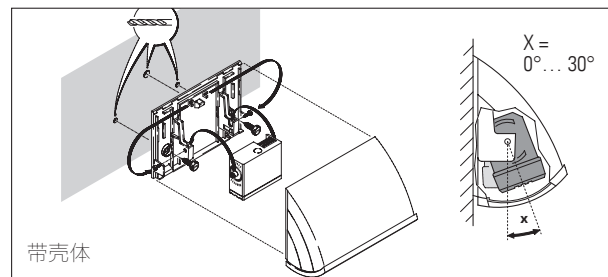

### 3 配线图

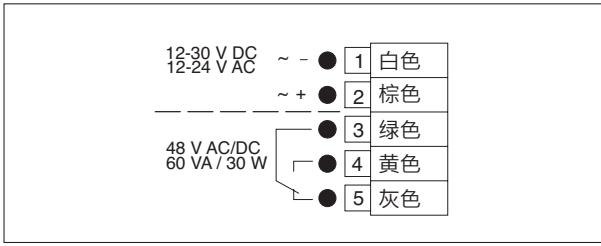

继电器未带电显示  
 线芯截面 = 0.25mm<sup>2</sup>

### 4 设置

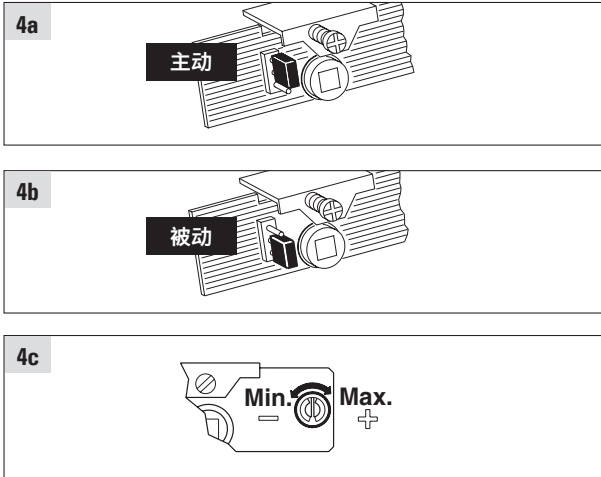

- 图 4a 主动模式 (常开), 当有探测时, 继电器得电有输出。
- 图 4b 被动模式 (常闭), 当有探测时, 继电器失电, 无输出。
- 图 4c 敏感度设定

### 5 检测区域

#### zoom螺丝调节

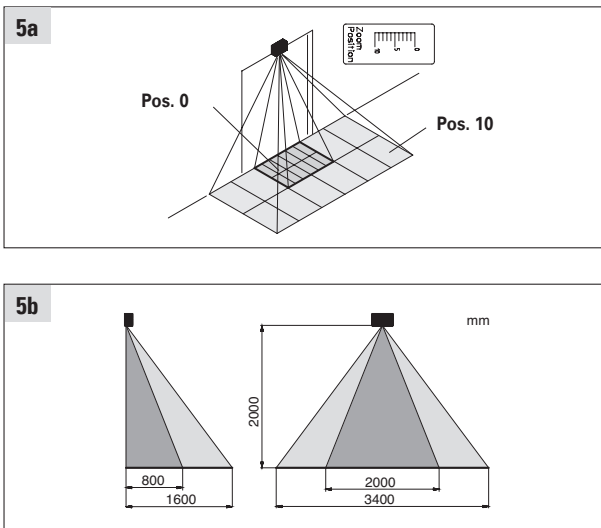

- 图 5a 和 5b
- 图示检测区域是不带遮挡片的。
- 选择最小的zoom位置时的检测区域。

### 遮挡片



图 5c 和 5d  
 图示区域为zoom螺丝在0位置的检测区域

### 6 技术数据

工作电压	12- 30 V DC -0% / +15% 12-24 V AC -0% / +15%, 50/60 Hz
功率消耗	DC: 21 mA, AC: 67 mA
工作温度	-40 °C ...60 °C
最大安装高度	4 m
最大探测范围尺寸	3.4 x 1.6 m
最低探测速度	0.1 m/s
落差延迟时间	0.5 秒
保护等级	IP52 (IEC 60529)
继电器触点负载	最大合闸电流 0.5 A AC / 1 A DC 最大接触电压 48 V AC/DC 最大开关容量 60 VA / 30 W

### 7 EU符合性声明

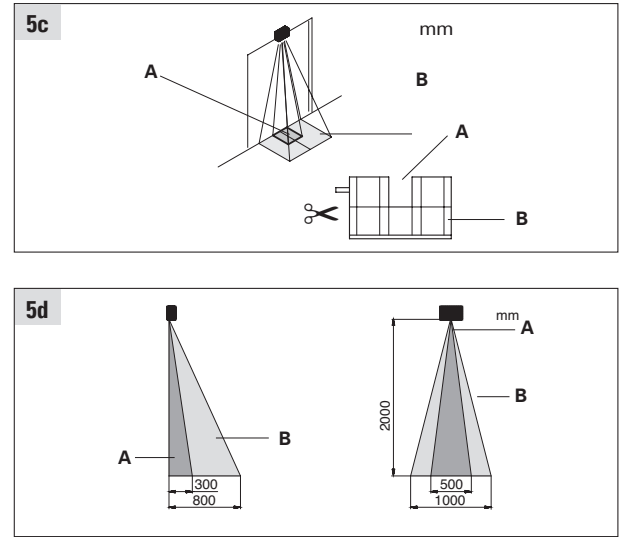
CE 参见附件

### 8 WEEE

在处置过程中, 带有此符号的设备必须单独处理。必须按照相应国家有关电子电气设备环境无害化报废、处理和回收的相关法律处理。

### 9 联系

BBC Bircher Smart Access, BBC Bircher AG  
 Wiesengasse 20, CH-8222 Beringen, www.bircher.com

Designed in Switzerland / Made in China

# PIR 22

## Passive Infrared Motion Detector

### Translation of the original operating instructions

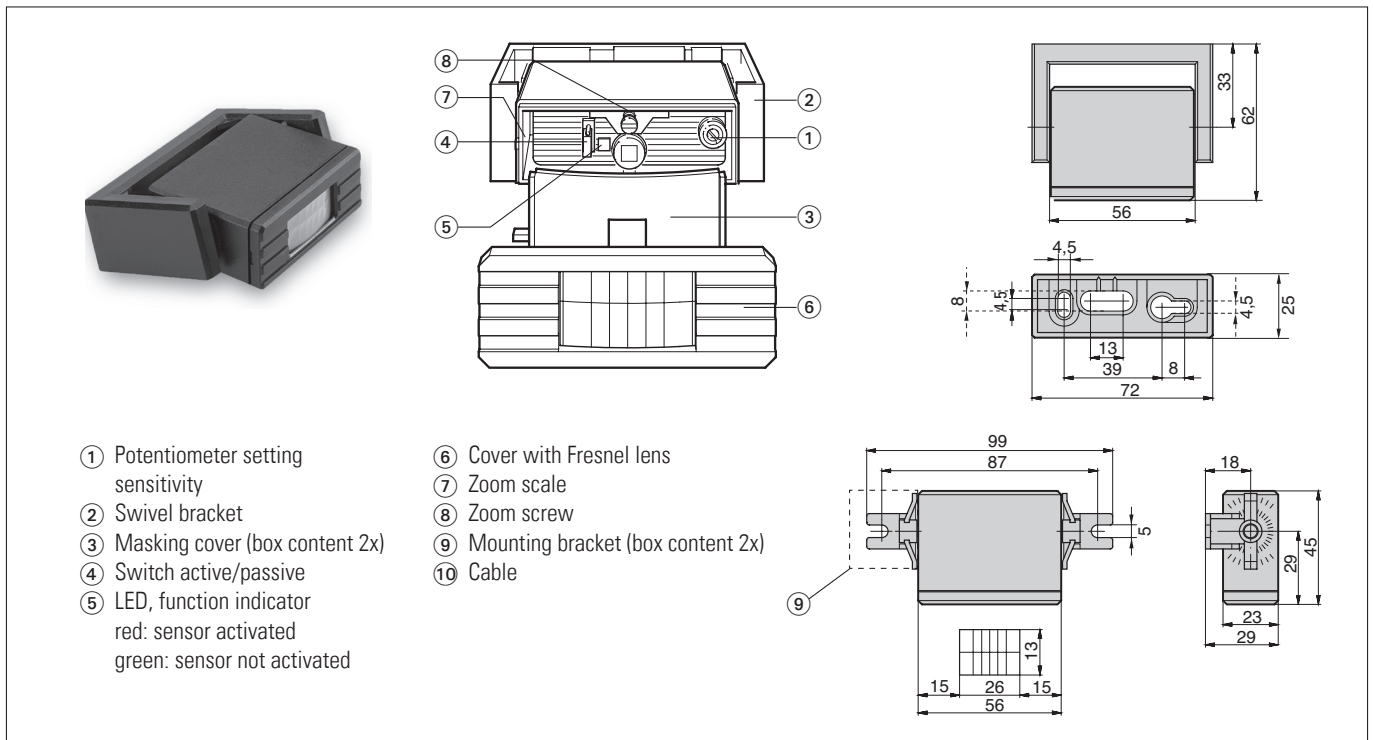

### 1 Safety instructions



• Read these operating instructions thoroughly before putting the device into operation and keep them for future reference. • This product is designed to be mounted above an overhead pedestrian door. • Not a safety component in accordance with the EU Machinery Directive; must not be used for personal protection or EMERGENCY STOP function. • Only trained and qualified personnel may install and initialize the device. • Failure to follow these safety precautions may cause damage to sensor or objects, serious personal injury, or death. • The installer is responsible for testing the system to ensure it meets all applicable safety standards. • The device should only be operated from a safety extra low voltage (SELV) system with safe electrical separation according to EN 61558. The wiring must be protected against mechanical damage. • Avoid touching any electronic and optical components.

### 2 Mounting

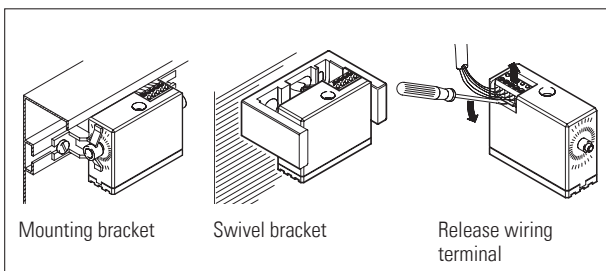

#### Ceiling mounting frame (Article No. 212822)

Dimensions ceiling mounting frame:  
width 110 mm, height 40 mm, depth 37 mm, lens area 14 x 27 mm

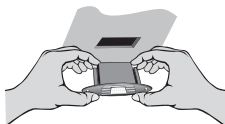

Cut out a hole for the frame in the ceiling (dimensions: 75 x 26 mm). Insert the sensor attached to the mounting frame, into the designated mounting area.

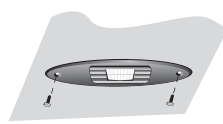

**Box content**  
2 screws (2.9 x 6.5 mm) for bracket mounting  
2 screws (3.9 x 19 mm) for ceiling mounting

#### Protection cover (Article No. 212827)

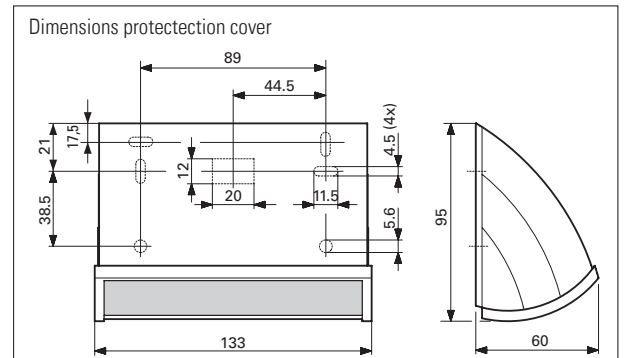
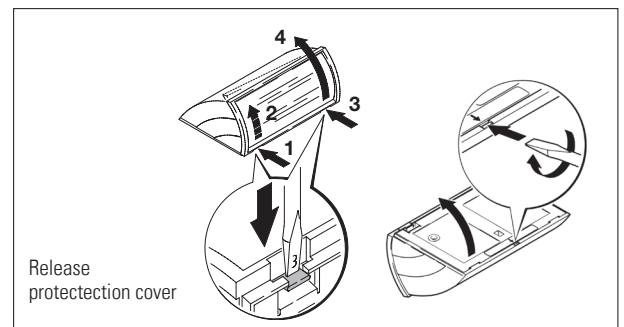
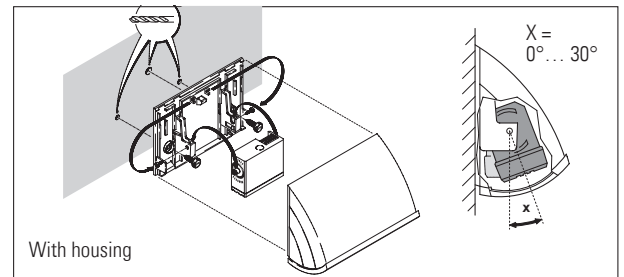

### 3 Wiring diagram

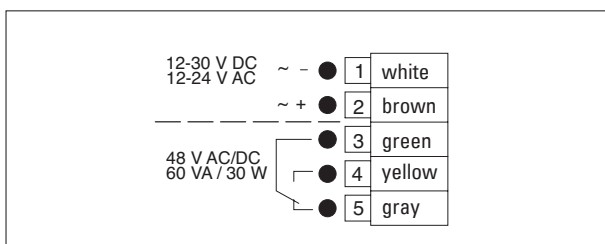

Relay shown unpowered  
 Wire cross section = 0.25 mm<sup>2</sup>

### 4 Settings

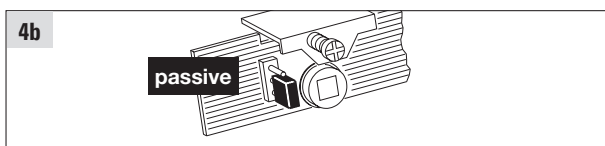
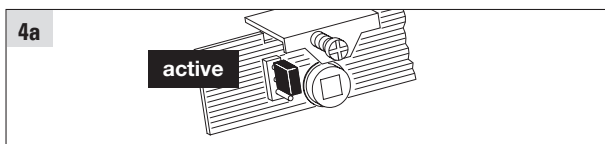

**Fig. 4a** Active (normally open n.o.), relay is activated when detection occurs.  
**Fig. 4b** Passive (normally closed n.c.), relay is deactivated when detection occurs.  
**Fig. 4c** Sensitivity

### 5 Detection zone

#### Zoom

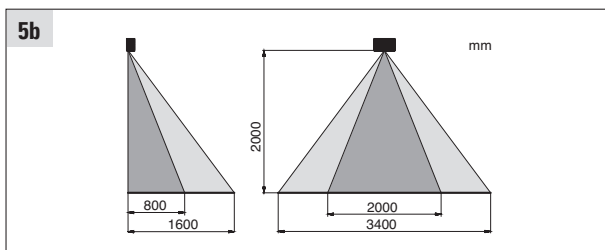
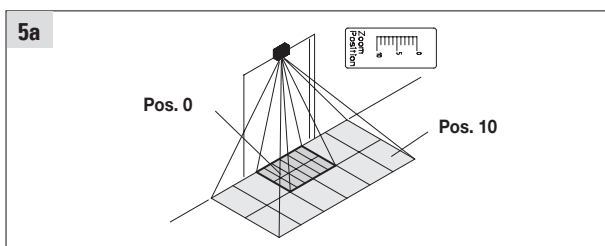

**Fig. 5a and 5b**  
 – Detection zone shown without masking cover (B).  
 – Choose the smallest possible zoom range.

### Masking cover

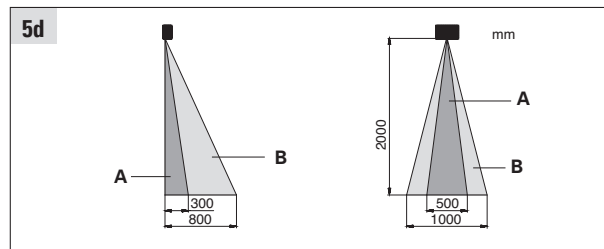
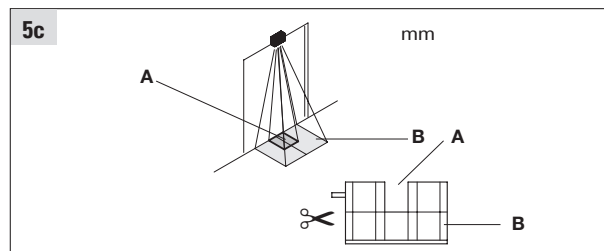

**Fig. 5c and 5d**  
 Detection zones shown with zoom Position 0.

### 6 Technical data

Operating voltage	12 – 30 V DC –0% / +15% 12 – 24 V AC –0% / +15%, 50/60 Hz
Power cons.	DC: 21 mA, AC: 67 mA
Operating temperature	–40 °C ... 60 °C
Installation height	max. 4 m
Field size	max. 3.4 x 1.6 m
Detection speed	min. 0.1 m/s
Fall-delay time	0.5 s
Protection class	IP52 (IEC 60529)
Relay contact load	max. 0.5 A AC / 1 A DC max. 48 V AC/DC max. 60 VA / 30 W

### 7 EU Declaration of Conformity

CE See attachment

### 8 WEEE

Devices with this symbol must be treated separately during disposal. This must be done in accordance with the laws of the respective countries for environmentally sound disposal, processing and recycling of electrical and electronic equipment.

### 9 Contact

**BBC Bircher Smart Access**, BBC Bircher AG  
 Wiesengasse 20, CH-8222 Beringen, [www.bircher.com](http://www.bircher.com)

Designed in Switzerland / Made in China