

RFGate 3.2.T

Transmitter for safety edges to RFGate 3 wireless signal transmission system

Supplementary sheet to the original instruction manual

General

Intended use: In combination with a receiver RFGate 3.x.R

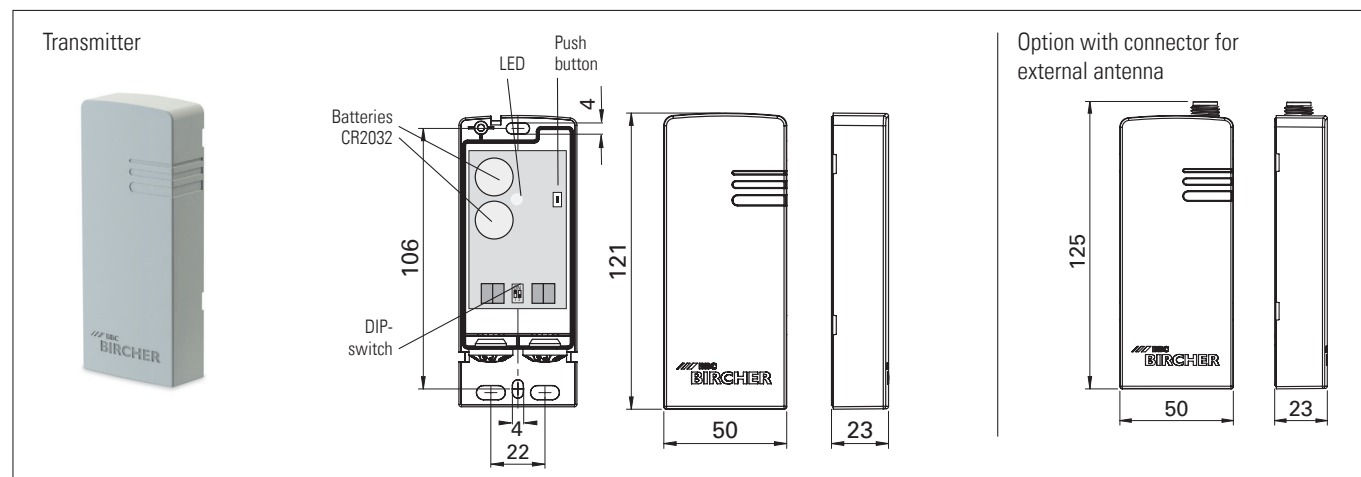

1 Safety instructions

i Battery life up to 2 years, but it is recommended batteries are changed every 12 months.

2 Wiring / set-up

2.1 DIP switch setting

DIP switch setting according to sensors
(safety edge, switch contact)

i Conductor cross section 0.25 – 0.75 mm²

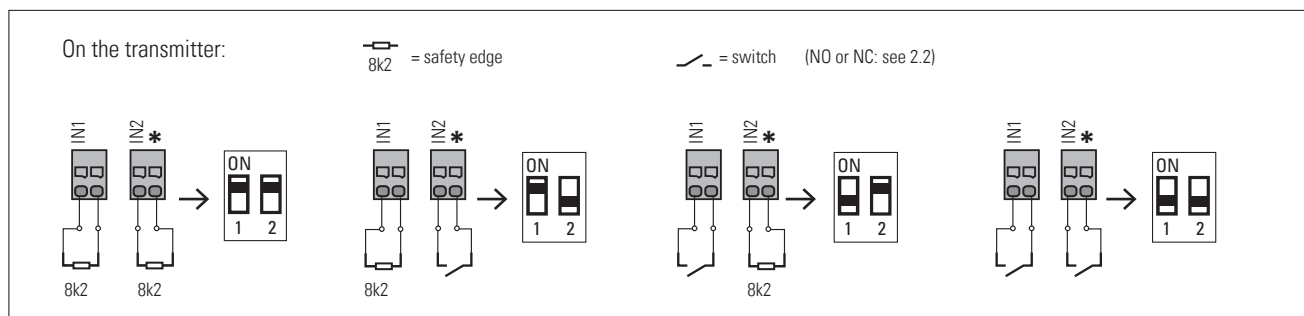

*** IN2 is only active when used with dual channel receiver RFGate 3.2.R with DIP switch 2 OFF**



2.2 How to change inputs from NC to NO (factory setting = NC)

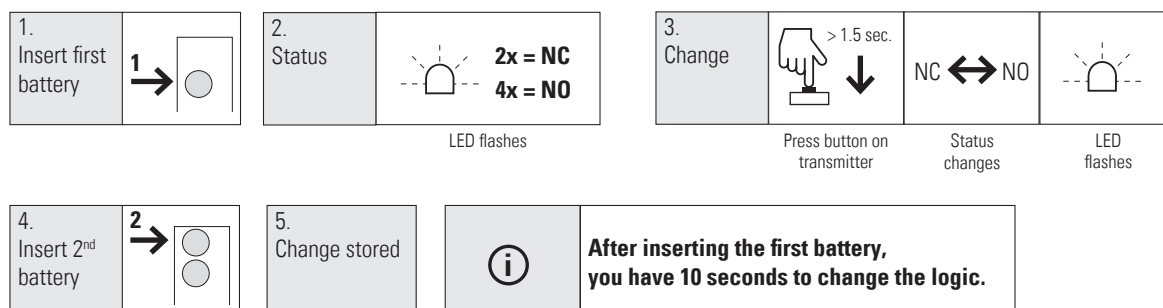

2.3 Cable routing, strain relief

- ① Determine the cable routing
- ② Break out the corresponding part of the cover if necessary
- ③ Punch hole into the grommet
- ④ Thread cable
- ⑤ Fix cable with the clamp (→ strain relief)
- ⑥ Cable Ø: 3.1 – 5.2 mm

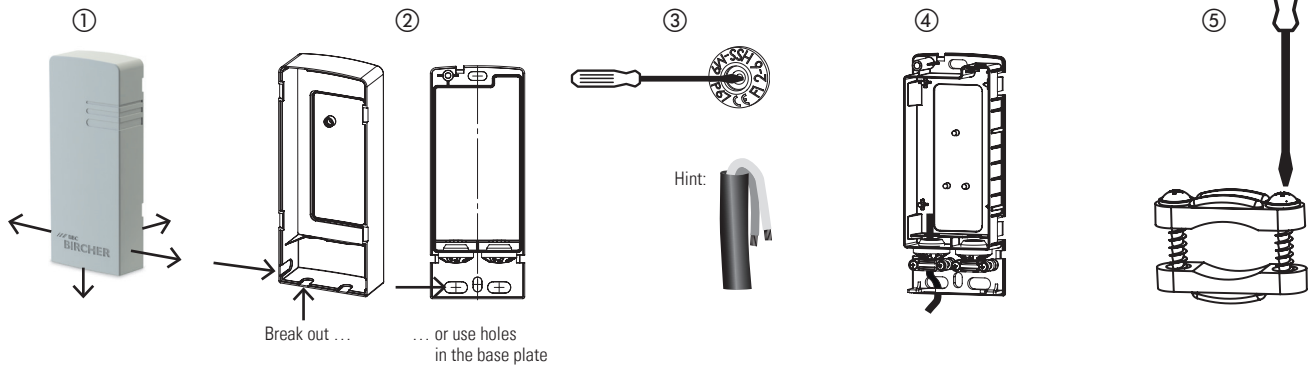

3 Installation sequence, set-up

→ See instruction manual of receiver.

4 Pairing transmitter with receiver

→ See instruction manual of receiver.

5 Maintenance

5.1 Warning indicator for low battery voltage

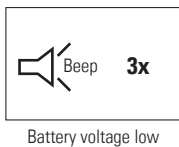

Receiver: 3 beeps every minute



To find out which transmitter has low battery voltage:
Press each edge. A beep indicates the low battery.

5.2 Battery change

- ① Open housing (screwdriver recommended)
- ② Remove batteries
- ③ Insert new batteries (take polarity into account)
- ④ Put on the cover

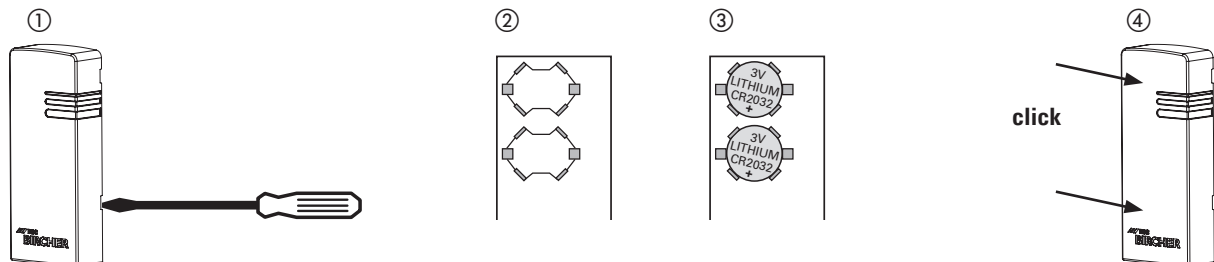

6 Technical data

| Transmitter | |
|-------------------|------------------------------------|
| Battery power | 2x Lithium 3 V Type CR2032 |
| Power consumption | Transmitting: 17 mA standby: 16 µA |
| Frequency bands | 869.525 MHz & 868.15 MHz |

| Optional | |
|----------------------|---|
| for external antenna | Connector SMA (f) for antenna with SMA connector (m) |

7 EU Declaration of Conformity



See attachment

8 WEEE



Devices with this symbol must be treated separately during disposal. This must be done in accordance with the laws of the respective countries for environmentally sound disposal, processing and recycling of electrical and electronic equipment.

9 Contact

BBC Bircher Smart Access, BBC Bircher AG, Wiesengasse 20, CH-8222 Beringen, www.bircher.com

Designed in Switzerland / Made in EU