

sensing the future

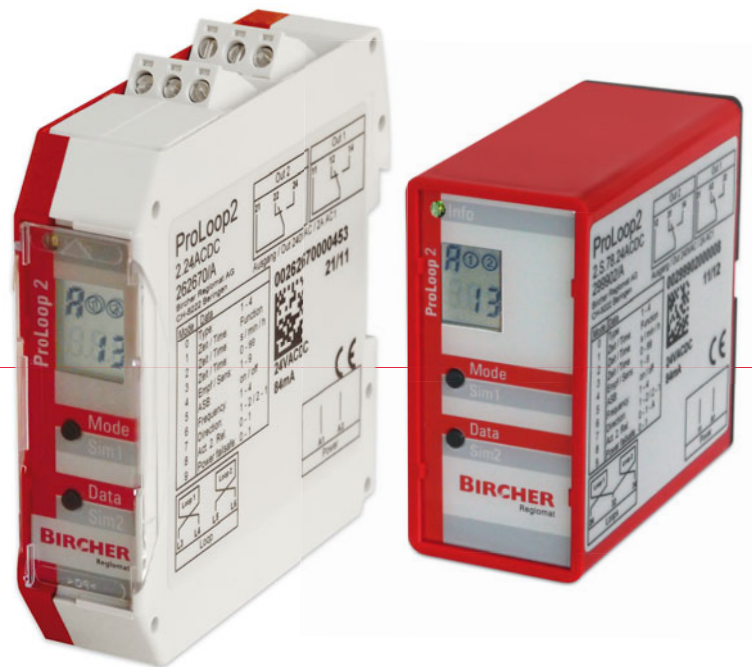

ProLoop 2

Loop detector for automatic industrial doors & gates and parking solutions

Intelligent, compact, reliable

- **Illuminated LCD display immediately shows fault detection**
- **Simple programming for quick & easy start up**
- **Multitude of functions and flexible settings**
- **Retention of detector settings & loop status after power failure**
- **Loop inductivity measurement and display on LCD screen**

ProLoop 2

Loop detector for industrial doors & gates and parking solutions

ProLoop 2 monitors and evaluates underground induction loops and recognizes metal in vehicles of all types including cars, forklifts, semi trucks (including those with additional trailers), and even motorcycles, bicycles & golf carts with precision. The intuitive operation with an easy-to-read LCD display makes ProLoop 2 a user-friendly choice. Because the loop is electrically isolated from the detector, highest levels of reliability are guaranteed. ProLoop 2 models are available as DIN-rail mount or 11-pin socket versions to ensure the highest flexibility for every application.

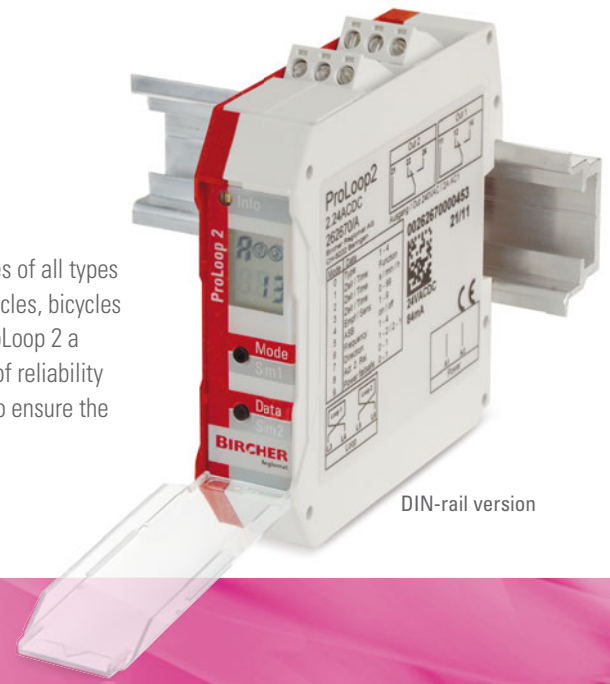

DIN-rail version



Key Features

Quick & easy start-up

With two buttons and an LCD display, programming ProLoop 2 is very straightforward & user-friendly.

Easy-to-read LCD display

The operating mode and parameters can be easily checked at a glance on the easy-to-read LCD display.

Fully adjustable for flexible applications

With 9 sensitivity adjustment levels, ProLoop 2 can be customized for any application.

Integrated induction measurement

Loop inductivity is measured and displayed on the LCD display.

Two outputs

Timing delays and other parameters can be individually programmed for each output.

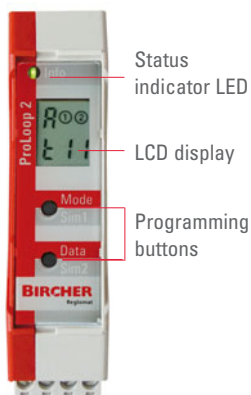



11-pin version

Pre-Assembled Loops

The pre-assembled underground induction loop is an important component of the loop detection system. A variety of circumference and supply cable configurations are available. Please contact Bircher Reglomat for more information.

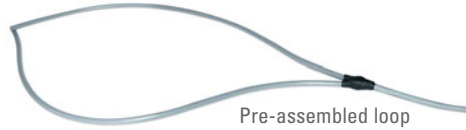

Pre-assembled loop

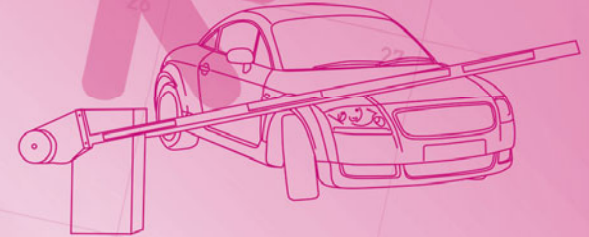

Applications

Overhead Doors

- Control of doors and light signals at entrances including bottlenecks with poor visibility
- Targeted activation by directional logic
- Reduced waiting times due to optimized traffic flow

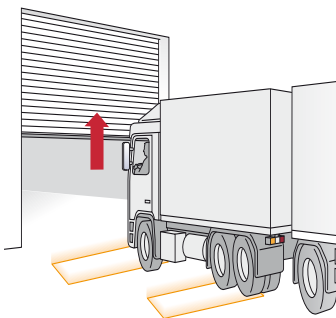

Sliding Gates

- Activates opening and closing of gates in indoor and outdoor areas
- Contact-free activation of gate installations

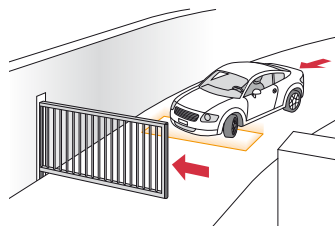

Entry Gates

- Activates opening and closing of barriers at entrances and exits of parking installations
- Can be used to activate ticket dispensing machines
- The opening pulse of the gate can be used as a counter to display real-time vehicle occupancy

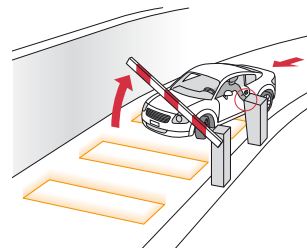

Traffic Bollards

- Activation of bollards at entrances, car parks, streets and pedestrian zones
- Detector settings and loop status are restored following power failure - prevents collisions between bollards & vehicles

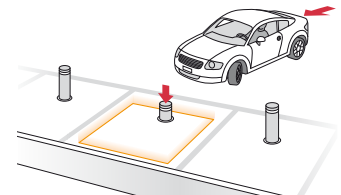

Order Details

Part no.	Description
----------	-------------

1-loop Detectors

262596	ProLoop 2 1.24 ACDC 1-loop detector with 2 relay outputs
262597	ProLoop 2 1.A.24 ACDC 1-loop detector with 2 relay outputs and alarm output
262598	ProLoop 2 1.LVAC 1-loop detector with 2 relay outputs
262599	ProLoop 2 1.A.LVAC 1-loop detector with 2 relay outputs and alarm output



2-loop Detectors

262670	ProLoop 2 2.24 ACDC 2-loop detector with 2 relay outputs
262671	ProLoop 2 2.A.24 ACDC 2-loop detector with 2 relay outputs and alarm output
262672	ProLoop 2 2.LVAC 2-loop detector with 2 relay outputs
262673	ProLoop 2 2.A.LVAC 2-loop detector with 2 relay outputs and alarm output

11-pin Connection Versions

299855	ProLoop 2 1.S.24ACDC, without plug-in base 1-loop detector with 2 relay outputs
299858	ProLoop 2 2.S.24ACDC, without plug-in base 2-loop detector with 2 relay outputs

Please contact Bircher Reglomat for additional product offerings and voltage options



Accessories

209745	BSF-11 plug-in base 11-pin socket to DIN-rail mount converter
256387	BOX22 Housing with NEMA 4 (IP55) rating Pre-assembled loops - available in a variety of sizes Please call Bircher Reglomat for details



Supplementary Products

ClickLine/CoverLine

Electrical safety edges for protecting the closing edge of automatic doors & gates



Hercules 2s

Microwave motion sensor for industrial doors



Technical Data

Physical Data

Housing Material	DIN	PA red/grey
	11-pin	11-pin connector base: PA black Hood: PPE red
Dimensions	DIN	7/8 x 3 3/4 x 3 1/2" (22 x 94 x 90mm)
	11-pin	1 3/8 x 3 x 3 1/2" (36 x 74 x 88 mm)
Weight	DIN	5 oz (140 g)
	11-pin	3.5 oz (100 g)
Connection type	DIN	Screw clamp terminals
	11-pin	11-pin connector w/screw clamps
Loop supply cable		Max. 330 ft (100 m) for 20–40 µH
		Max. 660 ft (200 m) for over 40 µH
		AWG 15 (1.5 mm ²) min. 6 twists/ft (20 twists/m)

Electrical Data

Supply voltage	DIN	24 V AC -20% to +10% 84 mA 24 V DC -10% to +20% 84 mA
		100–240 V AC ±10%, 50/60 Hz, 23 to 12 mA
	11-pin	24 V AC -20% to +10% 84 mA 24 V DC -10% to +20% 84 mA
Power consumption	DIN	Max. 2.9 VA
	11-pin	24 V, 1.2 VA
On duration		100%
Loop inductivity		Max. 20–1000 µH Ideal 80–300 µH
Frequency range		4 stages
Sensitivity		Frequency modulation: 0.01 – 1.00% in 9 stages
Hold time		Infinite (factory setting), or according to programming (2 independent time bases)
Loop resistance		< 8 Ohm incl. supply cable
Output	DIN	Loop: relay max. 240 VAC, 2 A / 30 VDC; 1.0 A Alarm: max. 40 VACDC, 0.3 A
	11-pin	relay 240 VAC, 2A, AC1
Reaction time		1-loop device: 25 ms 2-loop device: 50 ms
Max. vehicle speed		30 mph (50 kph) with appropriate loop
Compliance		R&TTE 1999/5/EC

Environmental Conditions

Protection class	NEMA 1 (IP20)
	NEMA 4 (IP55) with BOX22
Operating temperature	–4 °F to +140 °F (–20 ° to +60 °C)
Humidity	< 95 %, non-condensing

Bircher Reglomat

870 Pratt Ave N
Schaumburg, IL 60193
Phone 847-952-3730
Fax 847-952-2005
sales@bircherreglomat.com
www.bircherreglomat.com